

KE-8114SC & KE-8114SW

DIAPHRAGM VALVES (FOOD & SANITARY GRADE) CLAMP & BUTT-WELD ENDS

MOP: 10 BRA
MOT: 10~140°C(EPDM)
SIZE: 1/2" THRU 1"
VALVE BODY SURFACE FINISHES, INTERNAL FINISH
(ACC TO DIN 4768)

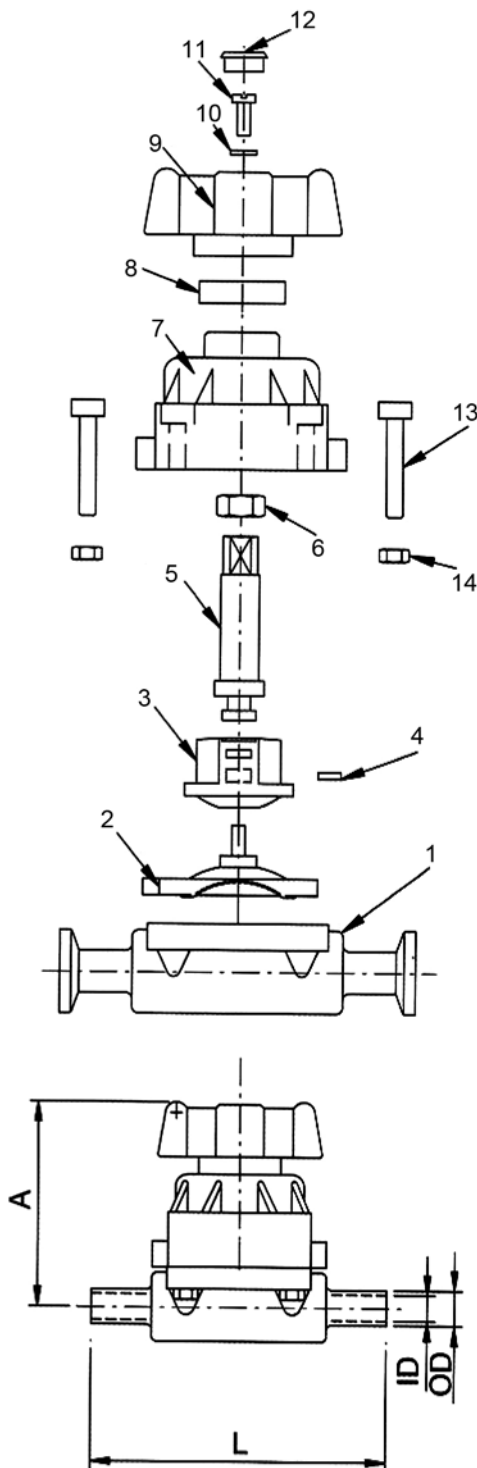

MATERIAL LIST

NO.	DESIGNATION	Q'TY	MATERIAL
1	DIAPHRAGM VALVE BODY	1	SS 316L
2	SEAL	1	EPDM
3	SEAT	1	PP
4	SEAT	1	ST
5	SCREW SHAFT SEAT	1	SS304
6	SCREW	1	SS
7	BONNET	1	NYLON
8	PP RING	1	PP
9	HAND WHEEL	1	NYLON
10	RING	1	PP
11	SCREW M4*10	1	SS
12	COVER	1	PP
13	SCREW M5*30	4	SS
14	M5 SCREW	4	SS

DIMENSIONS

Unit:mm

SIZE	ID	OD	A	L/WELD	L/CLAMP
1/2"	9.5	12.7	75	108	108
3/4"	15.8	19.05	75	108	108
1"	22.1	25.4	75	108	151